

Entwurfsdetaillierung

Tornesch am See

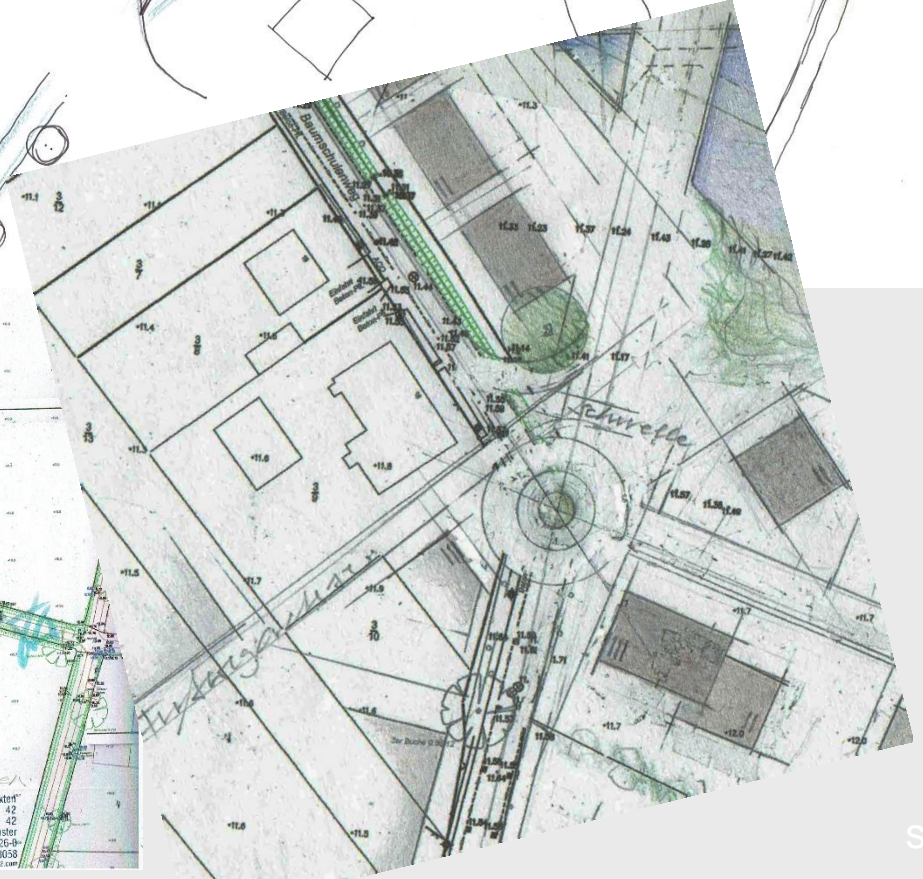

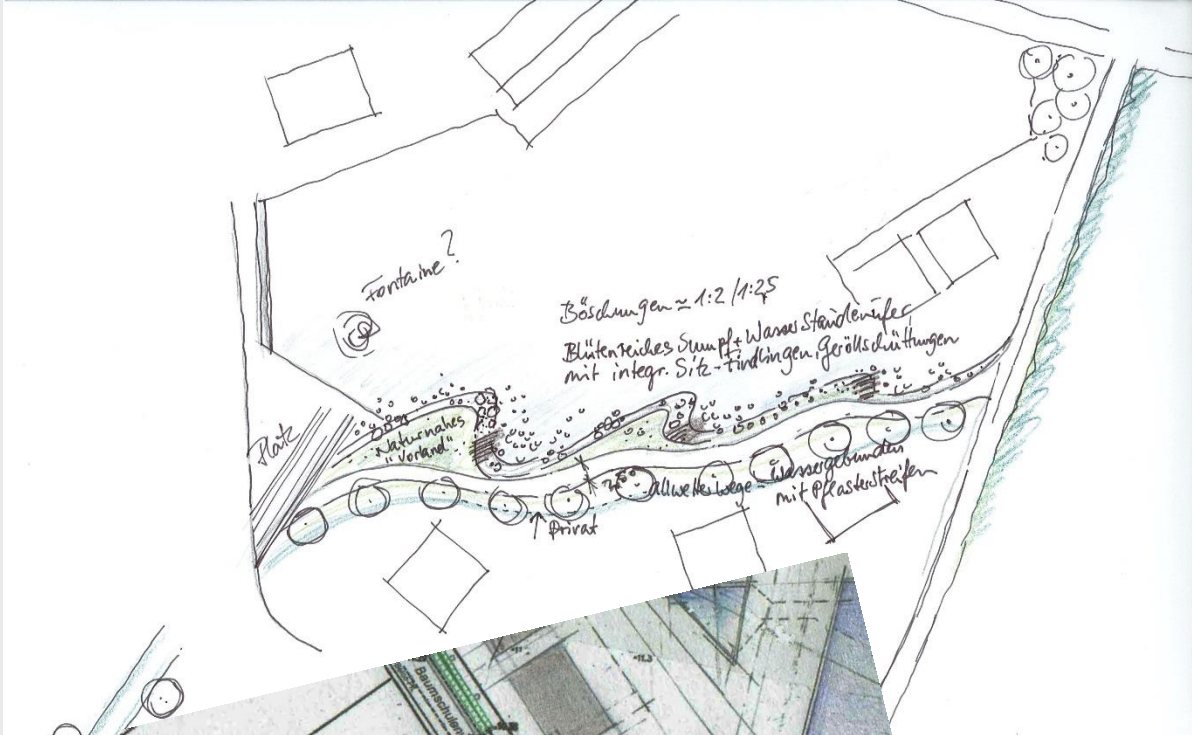





ZUMHOLZ LANDSCHAFTS-ARCHITEKTUR
 GROOTHOFFLEHMANN & JAHN HOCHSCHULESTADT TELEFON 0915 283-4511 FAX 0915 283-20
 0915 283-320

| | | | |
|---------------------------------|----------------------------|-----------------------|-----------------------|
| Projekt: TORNESCH AM SEE | | | |
| Projektnummer: BV1608 | Plan: L_001 | Index: B | |
| Dat: AB | Revised: 15.02.2017 | Gezeichnet: RW | Masstab: 1:500 |

Planinhalt: **Lageplan**

Architekt: 

Stab: 
 Stadt Tornesch
 Wirtshaus Str. 7
 25438 Tornesch

Wuttke Architekten - Studio42
 Bahnhofstr. 42
 D-24254 Neumünster
 Tel. 04321-41029-0
 Fax 04321-126-3058
 info@studio42.com
 www.studio42.com